

# PERSONAL TRACKER

The Personal Tracker is an autonomous tracker with GNSS, GSM and Bluetooth connectivity. This tracker is designed for the monitoring of people, pets and cars. It can also be applied for employee control, security staff at the sport events and other use cases to ensure security and control. IP67 waterproof case provides convenient usage, even in harsh conditions. The large battery capacity expands the application range where long battery life is needed.

## ALARM BUTTON

Easy to reach, instant messaging in case of emergency

## LIVE TRACKING

Real time monitoring of employee location

## INSIDE TRACKING

Get a live tracking information from inside the buildings with the help of BLE beacons

## MAN DOWN & NO MOVEMENT EVENT

Automated emergency alarm for no movement scenarios

## EXTRA SMALL

Dimensions only 44x43x20 mm. Such a device can be easily hidden and work for long hours

## BLE BEACON SUPPORT

Low power sensors and BLE Beacon support for various use cases



WORKERS



OFFICES & BANKS SECURITY



DRIVERS SECURITY



SCHOOL CHILDREN



PETS, FARM ANIMALS

## Hardware

Module name	Personal Tracker
Technology GNSS	GSM/GPRS/GNSS/Bluetooth (4.0 + LE) GPS,
Receiver	GLONASS, GALILEO, BEIDOU
Tracking sensitivity	33 channel
Accuracy	-165 dBm
Hot / Warm / Cold start	< 3 m
Cellular technology	< 1 / < 25 / < 35 s GSM
2G bands	Quad-band GSM 850 / 900 / 1800 / 1900 MHz
Data transfer	GPRS Multi-Slot Class 12(up to 240 kbps) GPRS Mobile Station Class B SMS
Data support	(text/data)
Power	3.8 V 800 mAh rechargeable Li-ion battery

## Interface

GNSS antenna	Internal High Gain
GSM antenna	Internal High Gain
Bluetooth antenna	Internal High Gain
Sensors	Accelerometer
USB	4 pin magnetic USB Cable
Interface Buttons	Internal Micro-SIM Slot, 128 MB internal flash memory (220'000 records) 2 configurable buttons
Indication	RGB LED, Vibration

## Software

Configuration and firmware update	Cloud configuration & Configuration through SMS
Scenarios	Alarm button, Man-down detection, Home zone, Inside tracking, Movement/No Movement Events, 50 Manual Geofence zones, Over Speeding, Action on call feature, Real Time tracking, Smart algorithm of GPRS data sending for GPRS traffic saving, Asset tracking
Sleep modes	Online Deep Sleep, Deep Sleep, Ultra Deep Sleep, Low power mode
Protocols Data	UDP/TCP/SMS
sending	Primary, Duplicate and Backup servers
Security	Configuration password, SMS login and password, Authorized GSM numbers list, TLS
Time Synchronization	GNSS, NITZ, NTP
Supported peripherals	Bluetooth LE Movement sensors, LE Magnet sensors, LE Temperature and Humidity sensors and LE Temperature sensors support, iBeacon and Eddystone beacon support.

## Physical specifications

Dimensions	44 x 43 x 20 mm (L x W x H)
Ingress Protection Rating	IP67

## Certification & approvals

Regulatory	CE/RED, EAC, RoHS, REACH, ANATEL (pending), UKCA (pending)
------------	--

## TOP VIEW

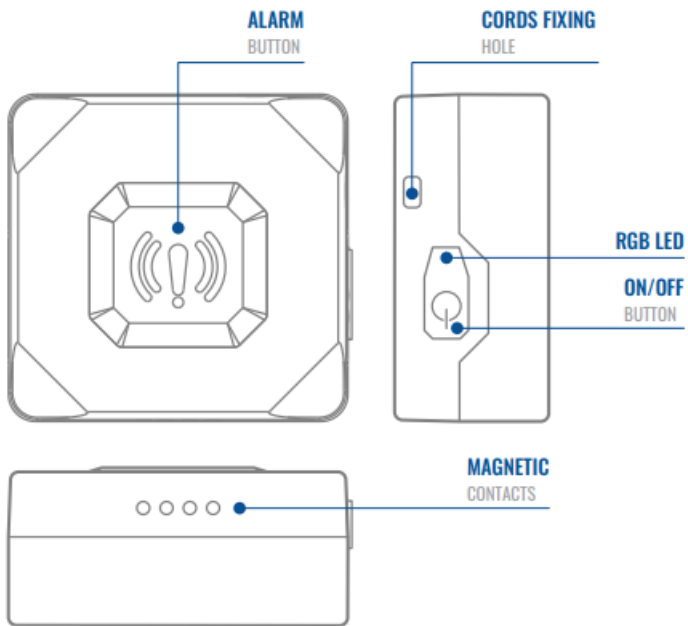

## TOP VIEW (WITHOUT COVER)

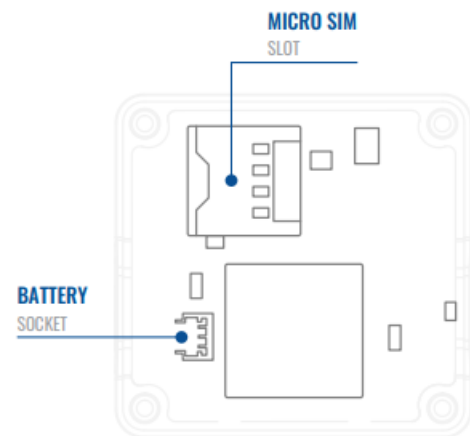

Here is what each colour indicates on the light on the device.

Device Off long Press Power button	Light is Red & <b>Vibration</b>
Device On Click any button	Green light & <b>Vibration</b>
Charging plugged in	Light is Green Flashing
Charging plugged in check connection	Light is flashing Red
Fully Charged	Light is Green Solid
Battery Low under 10%	Light is Red